

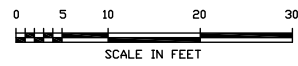

# 1<sup>st</sup> floor Eugene Short Hall

**100L1** (Next to Men's restroom):  
2 x Large green bin (paper/plastic)  
Medium green bin (can)  
**114A** (Outside of 114D):  
Large bin (paper)  
**119** (Next to cabinet):  
Medium bin (paper)  
2 x small bin (plastic/can)

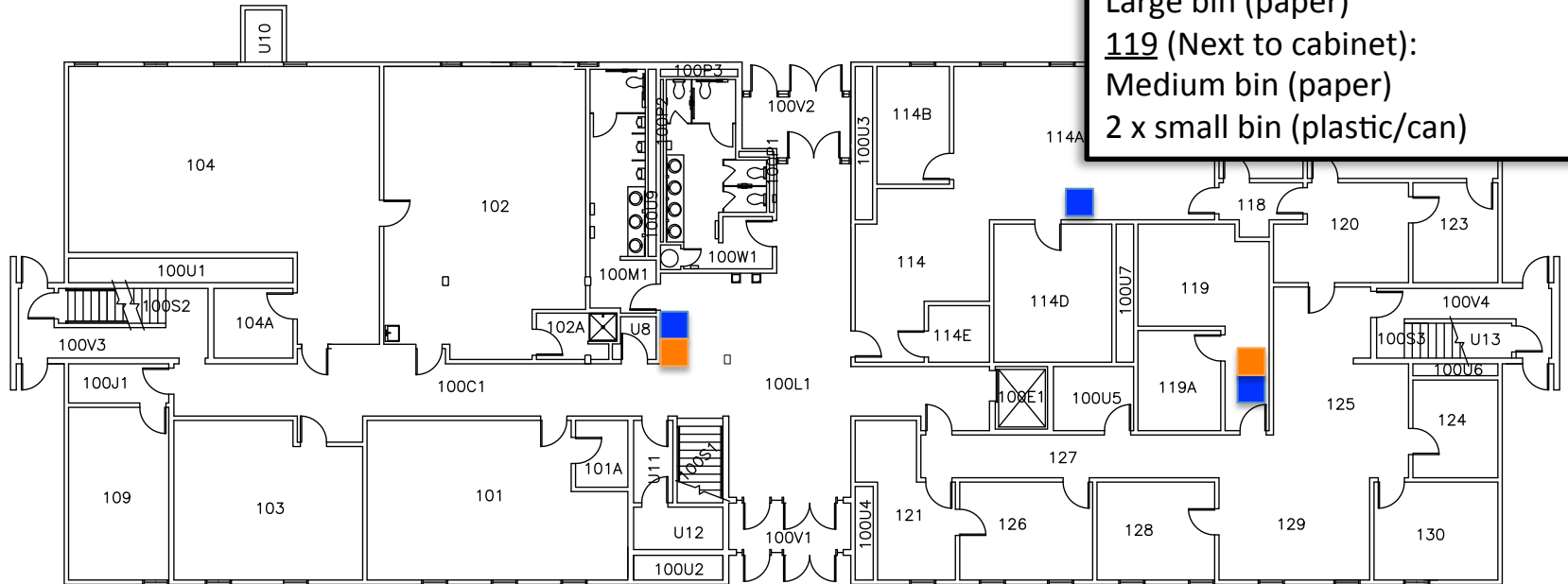

 = Mixed Paper Recycle Bin

 = Plastic and Can Recycle Bin

# 2<sup>nd</sup> floor Eugene Short Hall

**208 (AK Quarterly Review):  
Large bin (paper)**

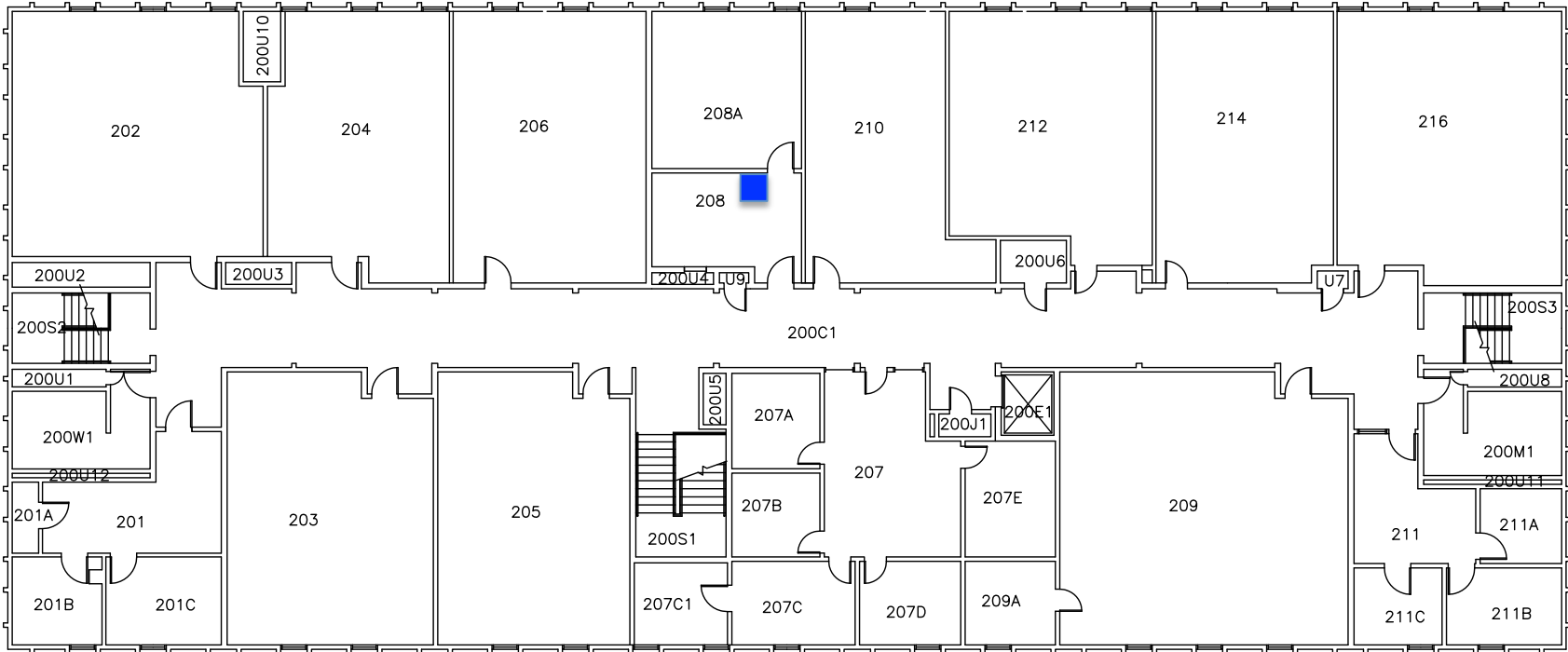

 = Mixed Paper Recycle Bin